



## **56 Bridge Street**

Pinner, HA5 3JF

### **Freehold Self-Contained Rear Warehouse.**

**770 sq ft**

(71.54 sq m)

- Excellent freehold opportunity for investors.
- Pinner Metropolitan Underground Station (0.3 miles).
- To be sold with VP.

# 56 Bridge Street, Pinner, HA5 3JF

## Summary

Available Size	770 sq ft
Price	£350,000
Business Rates	Upon Enquiry
VAT	Applicable
Legal Fees	Each party to bear their own costs
EPC Rating	Upon enquiry

## Description

A self contained warehouse located in a prime position in Pinner, slightly off the main road.

The warehouse is currently vacant and benefits from a manual roller shutter and accessed via a separate service road adjacent of off Bridge Street.

## Location

The property is located on the north-east side of Bridge Street, in a prominent position in the centre of Pinner. The premises are close to numerous well-known retailers such as Lidl, Sainsbury's, Marks & Spencer, Starbucks, Café Nero, Zaza's, and WH Smith. Pinner Metropolitan line underground station is within 0.3 miles of the property. Parking is available either by way of on street pay and display bays (1 hour free) or in Chapel Lane & Love Lane public car parks both within 0.2 miles.

## Accommodation

The accommodation comprises the following areas:

Name	sq ft	sq m	Availability
Ground - Rear Warehouse	770	71.54	Available
<b>Total</b>	<b>770</b>	<b>71.54</b>	

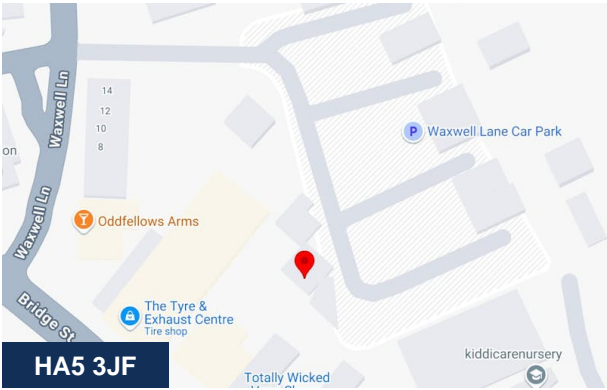

## Viewing & Further Information



**Finlay Milnes**  
020 8429 9009 | 07522 700 508  
finlay@davidcharles.co.uk



**George Moriarty**  
020 8429 9003 | 07522 700 507  
george@davidcharles.co.uk

The above information contained within this email is sent subject to contract. These particulars are for general information only and do not constitute any part of an offer or contract. All statements contained therein are made without responsibility on the part of the vendors or lessors and are not to be relied upon as statement or representation of fact. Intending purchasers or lessees must satisfy themselves, by inspection, or otherwise, as to the correctness of each of the statements of dimensions contained in these particulars. Generated on 05/01/2026



# Bridge Street, Pinner, London, HA5

Approximate Area = 1312 sq ft / 121.8 sq m

For identification only - Not to scale

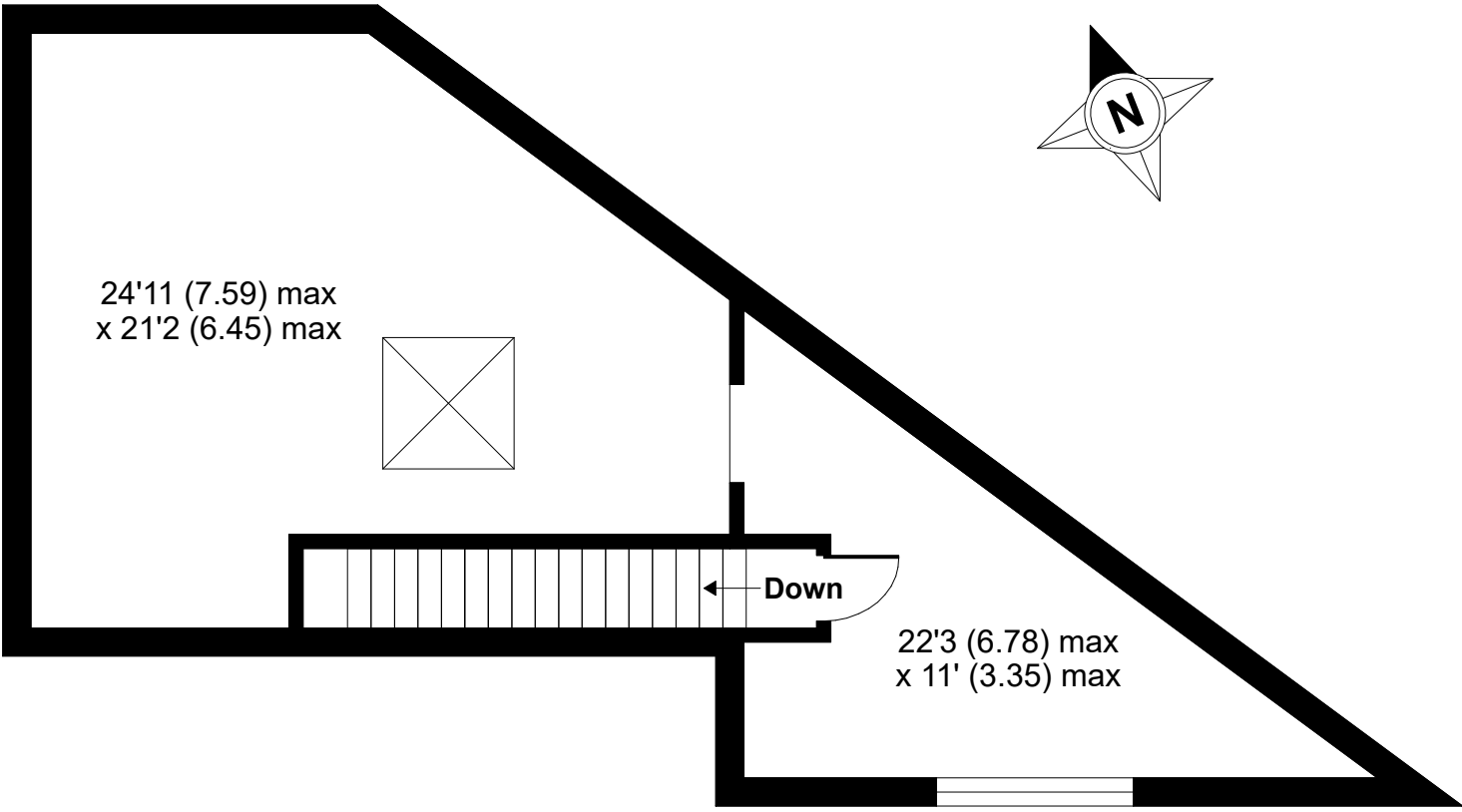

FIRST FLOOR

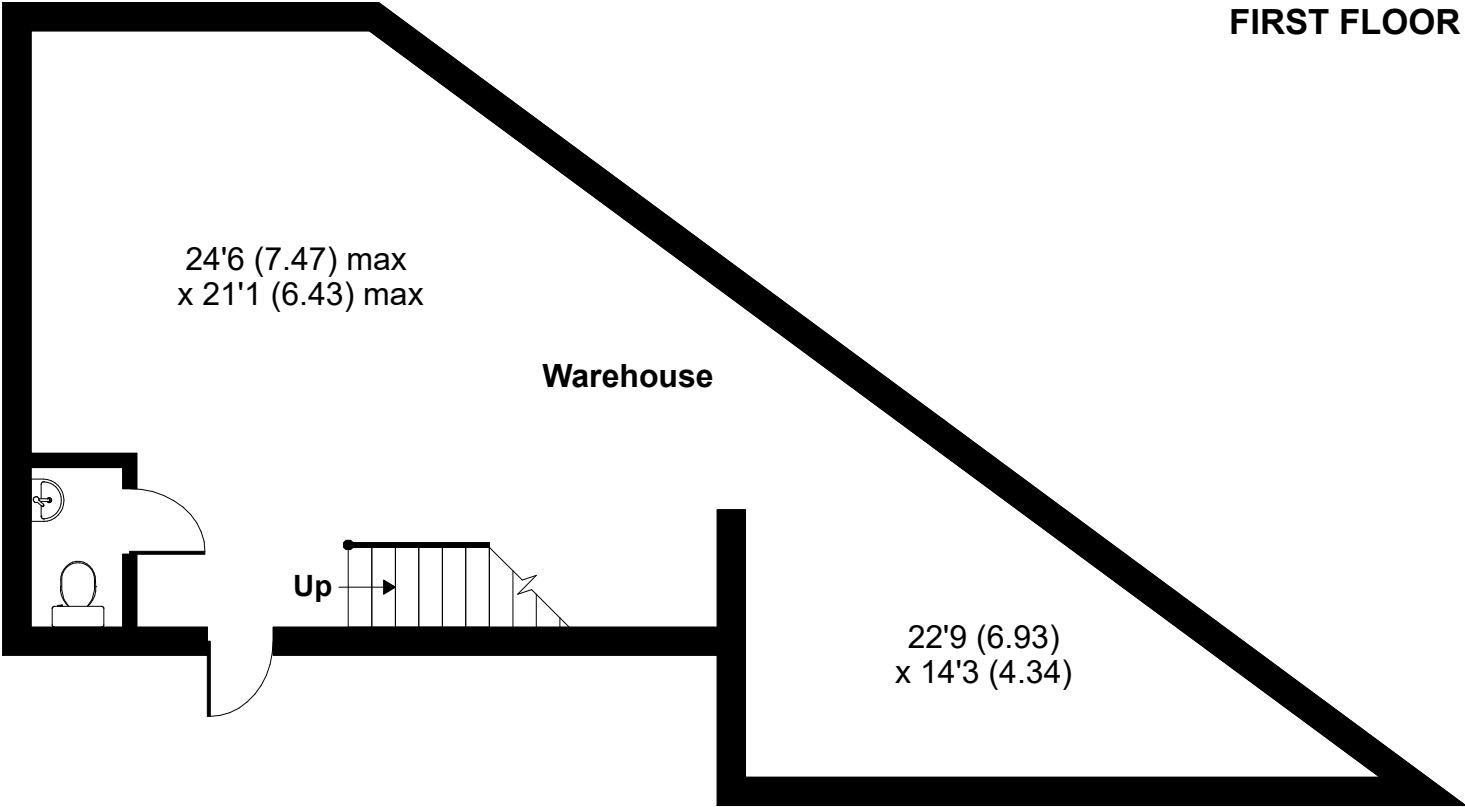

GROUND FLOOR